

## A 2

einseitige Winkelaschen  
bent attachments,  
one side

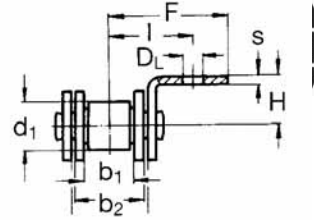
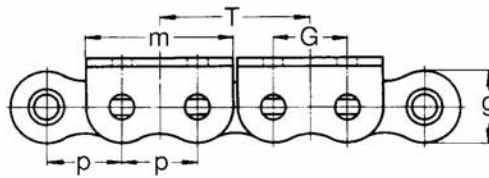

## B 2

zweiseitige Winkelaschen  
bent attachments,  
both sides

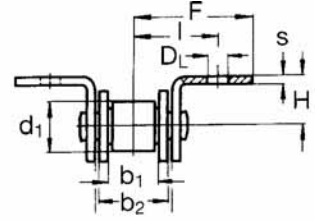
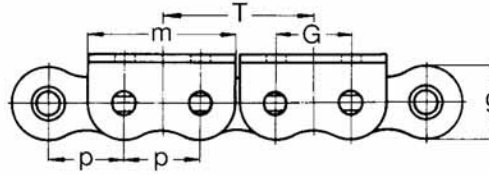

## D 2

einseitige Flachlaschen  
straight attachments,  
one side

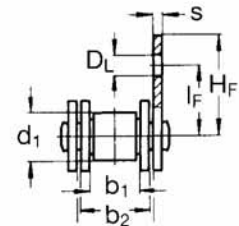
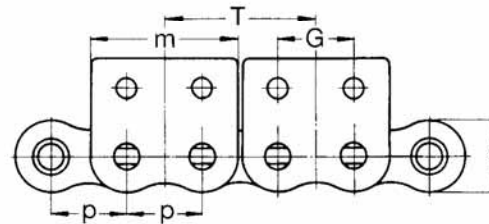

## E 2

zweiseitige Flachlaschen  
straight attachments,  
both sides

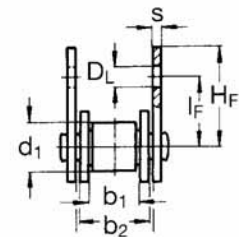
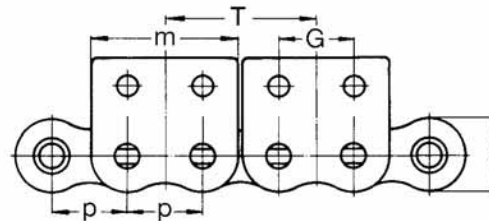

		Similar DIN/ISO	Teilung	Innere Breite	Innen- glied- breite	Rollen- Ø	Laschen- höhe	Bruch- kraft	Mitnehmer-Maße									
			Pitch	Inner width	Inner link width	Roller- Ø	Plate height	Breaking load DIN	Attachement dimensions									
No.	No.	p	b <sub>1</sub> min.	b <sub>2</sub> max.	d <sub>1</sub> max.	g max.	F <sub>B</sub> min.	m	D <sub>L</sub>	G	I	F	H	I <sub>F</sub>	H <sub>F</sub>	s		
		mm	inch	mm	mm	mm	N	mm	mm	mm	mm	mm	mm	mm	mm	mm		
WT 06 <sup>1</sup>	06 B-1	9,525	3/8	5,72	8,53	6,35	8,2	9 000	18,2	3,2	9,525	9,8	13,2	5,7	9,2	12,6	1,25	
WT 08	08 B-1	12,7	1/2	7,75	11,3	8,51	11,8	18 000	23,2	4,5	12,7	13,1	19	10	14,7	20,3	1,5	
WT 10	10 B-1	15,875	5/8	9,65	13,28	10,16	14,7	22 400	28,5	5,5	15,9	16,7	27	10	17,2	26,7	1,7	
WT 12	12 B-1	19,05	3/4	11,68	15,62	12,07	16,1	29 000	33,6	6,6	19,1	18,6	29	11	18,7	29	1,8	
WT 16	16 B-1	25,4	1	17,02	25,4	15,88	21	60 000	46,5	9	25,4	28,9	42	18	28,6	41,5	3	
WT 20	20 B-1	31,75	1 1/4	19,56	29	19,05	26,4	95 000	55,7	9	31,75	33,4	50	18	30,5	45,7	3,75	
WT 24	24 B-1	38,1	1 1/2	25,4	37,9	25,4	33,4	160 000	77	11	38,1	44	63	25	41	60	5	

<sup>1</sup> nur mit geraden Laschen / <sup>1</sup> with straight side plates only